

# Easyrig<sup>®</sup> 3 Gimbal Rig



## Gimbal Rig

**User Manual**  
Setup and Adjustment

# Easyrig 3 with GIMBAL RIG Specifications

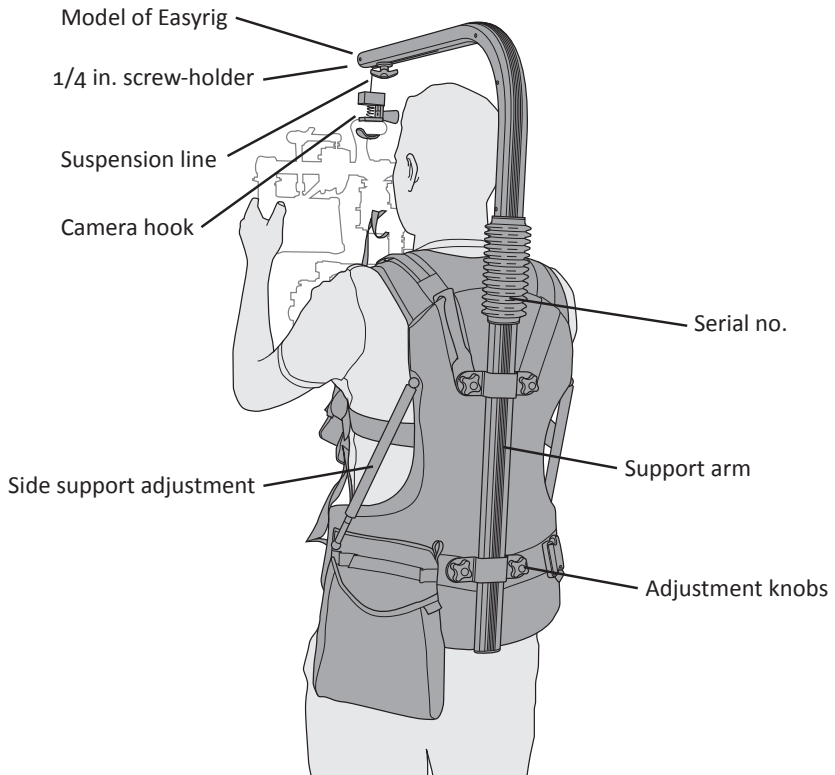

Weight complete with Gimbal vest adjustable arm +130 .....	4,1 kg (9 lbs)
Height (mounted) .....	90–100 cm (35–39 in)
Height (folded) .....	60 cm (24 in)
Suspension line (fully stretched) .....	88 cm (35 in)
Load range .....	see diagram on page 7

Designed and made in Sweden - [www.easyrig.com](http://www.easyrig.com)

# Congratulations on your new Easyrig 3 GIMBAL RIG!

The Easyrig 3 GIMBAL RIG is patented and specially designed by a photographer for professional photographers. Easyrig 3 GIMBAL RIG is manufactured in Sweden and has been ergonomically tested with optimal results.

The Easyrig 3 GIMBAL RIG gives you the same advantages as our other Easyrig models with the added benefit of being able to adjust the line tension to adapt to many different cameras and configurations. The Easyrig Easyrig 3 GIMBAL RIG still delivers the same steady hand held shots while relieving strain on your back, neck and shoulders. The load is redistributed to the hips allowing you to shoot hand held in comfort for hours.

The Easyrig 3 GIMBAL RIG will be your best tool when it comes to hand held shooting for Movies, Commercials, Television and any other situation where stability and freedom of movement is crucial.

The Easyrig 3 GIMBAL RIG is manufactured in Sweden and is built to the highest standards. The Easyrig 3 GIMBAL RIG is ergonomically designed and field tested to achieve maximum results.

To get the most out of your Easyrig 3 GIMBAL RIG, please read this user manual carefully.

Thank you for your investment in the Easyrig 3 GIMBAL RIG.

Good Luck!

Camerman and  
Inventor of Easyrig



Johan Hellsten

## Using the Easyrig 3 GIMBAL RIG

It's easy to get into the Easyrig 3 GIMBAL RIG vest, just as with a backpack. Your Easyrig 3 GIMBAL RIG is loaded with adjustments for your customized comfort.

When the vest is adjusted properly you should feel the weight of the camera primarily on your hips. It is also important that the support bar is vertical. If not, the load will be unevenly distributed on the hips causing the camera to possibly contact the bar.

The waist belt adjustment should be tightened so that the vest doesn't slide down around the hips but sits firmly on the hips. The shoulder straps are mainly for support and balancing the Easyrig. They prevent it from tilting.

When attaching the hook onto the camera, you might find it easier to set the camera on a table or a bench first. Try and find the balancing point of the camera then secure the hook at that point on the handle and tighten the lock on the camera hook.

Don't forget to fasten the safety line between the camera handle and the vest.

## Shooting from the Hip

The Easyrig 3 GIMBAL RIG gives you the freedom to shoot at various height levels, from the shoulder to the waist by simply moving the camera down from your shoulder. You should feel only a fraction of the camera's weight.

When shooting at hip level, lean slightly backwards while pushing the camera forward. This will minimize the load on your back. The length of the suspension line makes it possible to position the camera as far as your arms can reach.

# Getting started with the Easyrig 3 GIMBAL RIG

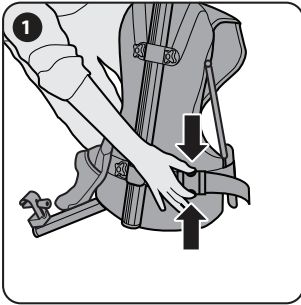

**Fig. 1**  
Unlatch the buckle and unfold the support arm.

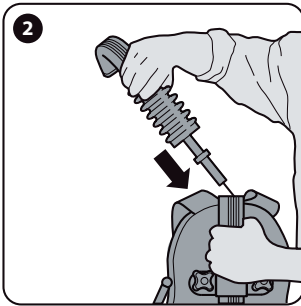

**Fig. 2**  
Let the tube attached to the support arm slide into the lower tube section and pull over the bellows.



**Fig. 3**  
Put on your Easyrig 3 GIMBAL RIG. Adjust the hip belt until you find the rig comfortable. Pull the belt tightly.

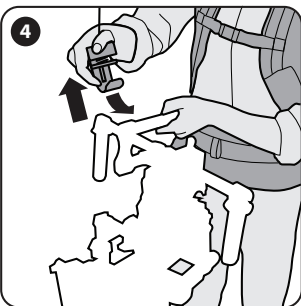

**Fig. 4**  
Attach your camera to the Easyrig. Use your middle finger to open the hook. Secure the hook by turning the knob clockwise. **Fasten the safety line.**

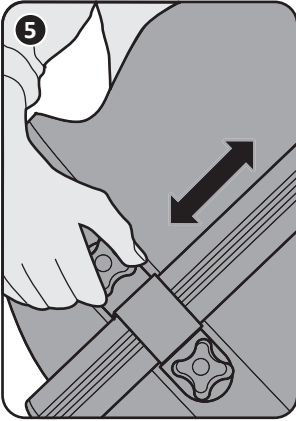

**Fig. 5**  
If adjustment is needed, loosen the knobs and move the hip and back support to find the right position.

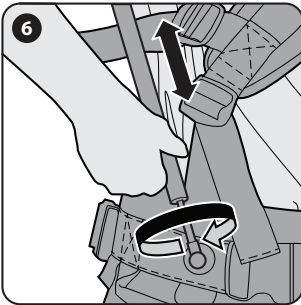
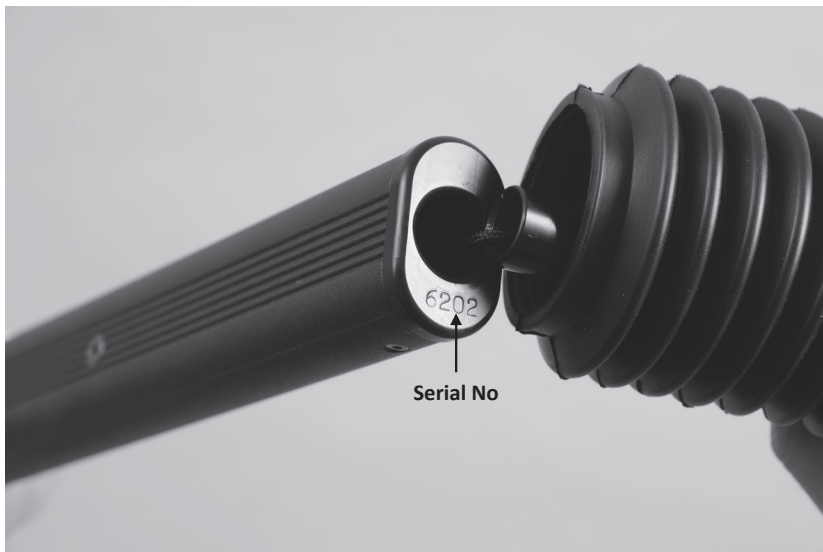
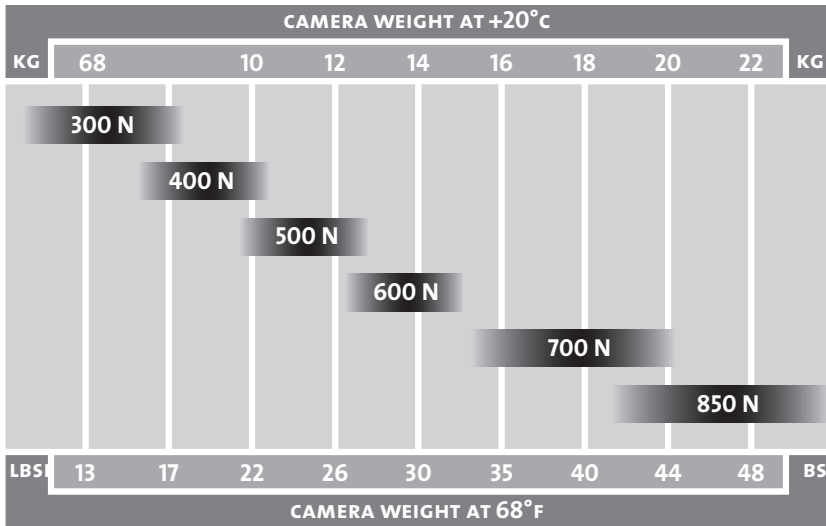

**Fig. 6**  
By adjusting the side supports you will move the weight on your hips.



**Fig. 7**  
Adjust the chest strap if necessary, but don't pull it too tight. Your Easyrig 3 GIMBAL RIG is now ready to be used.

## Powered shock absorber selection guide:



## Safety precautions!



Always hold the camera when working with the Easyrig 3 and Always attach the safety strap between the camera and the Easyrig 3 vest shoulder loop.

**Never undo the waist belt buckle when the camera is attached to the Easyrig 3! If the waist buckle is released while the camera is attached, the weight of the camera will pull the top of the Easyrig 3 down, and could cause you to lose control of the camera.**

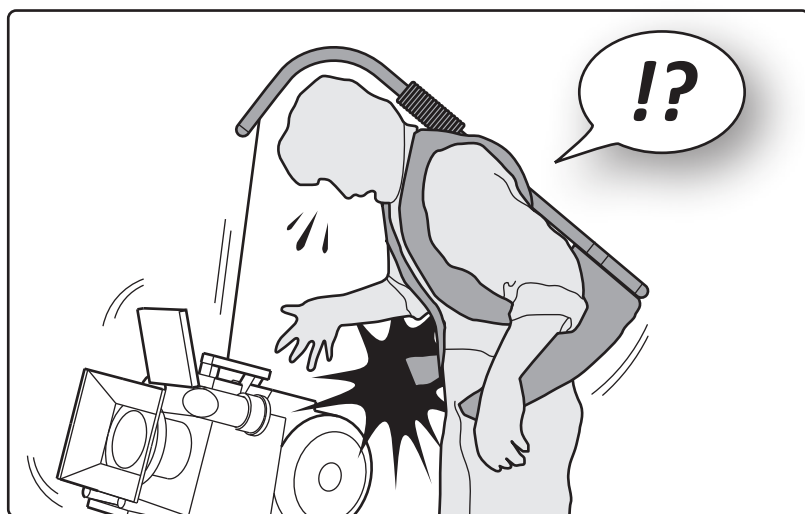

If you fall into water while wearing the Easyrig 3, it's important to get the equipment off quickly. Just release the waist, chest and shoulder strap buckles. Then slide the shoulder straps over and off of your arms.

Be especially careful when filming in rugged terrain. Make sure to wear appropriate comfortable shoes and clothing. If you work with the Easyrig 3 under special conditions, i.e. in a car, boat, plane or helicopter, always use a safety belt or harness.



## Some practical advice

- Try to keep the camera as close to your body as possible, to avoid unnecessary strain on your back.
- When filming upwards, you might find it easier if you have the camera tucked under your arm.
- When filming at hip level during longer periods of time, rest the camera on the hip belt to increase stability.
- Use the Easyrig 3 for transporting your camera to and from the filming site.
- When folding your Easyrig 3 for storage, always make sure to tuck the upper part of the support arm inside the hip belt and fasten the buckle at the back of the hip belt. This will prevent the suspension line from wearing.
- If your Easyrig 3 will be inactive for more than a couple of months, make sure to store it standing up. This will keep the shock absorber gasket from drying out.
- Use mild soap if you want to get rid of dirt on the vest.
- Check the rope from wear and tear at least once every month.

“Easyrig is an effective ergonomic relief aid for back and shoulders, intended for camera operators working with hand held cameras. A considerable load relief has been ascertained. The aid provides a good basis for improvement of back health. The results show that this aid can give long-term benefits in the form of improved back health, work effectiveness and picture quality.”

***Elisabeth Schell, Authorized ergonomist and registered physiotherapist, Swedish Television***

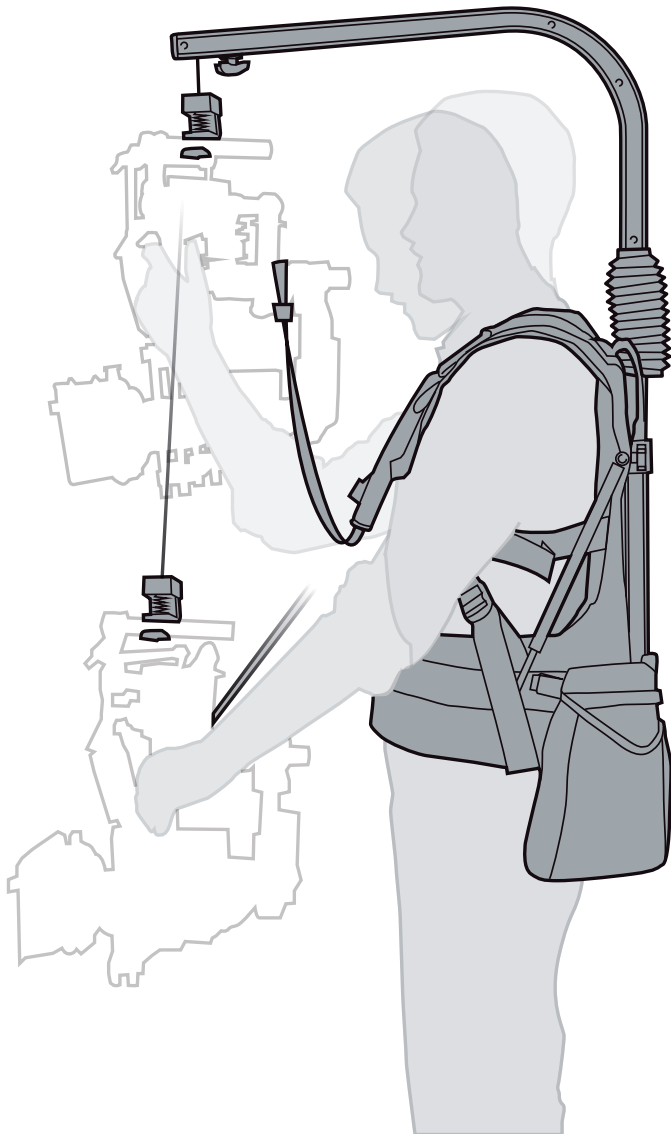

# Easyrig 3 GIMBAL RIG limited Warranty

Manufacturer's products are warranted to be free from defects caused by faulty materials or workmanship for a period of two years from the date of purchase. The liability of the Manufacturer under this warranty is limited to repairing, replacing, or at its option issuing credit for any of its products which are returned by purchaser during such period provided, however, that:

- A. Warranty card is properly filled out and returned to Manufacturer within 30 days of purchase.
- B. Defective merchandise is returned to Manufacturer accompanied by a report of findings indicating the basis of/for rejection and with transportation charges paid by the purchaser.
- C. That such defects exist and have not been caused by abuse, misuse, neglect, improper installation or assembly, repair, alteration or accident.

In no event shall Manufacturer be liable for collateral or consequential damages of any nature. This warranty is in lieu of all other warranties expressed or implied.

---

## Easyrig 3 Warranty Information Card

Registration of your newly bought Easyrig can also be done on our website [www.easyrig.com](http://www.easyrig.com).

[please fill in and mail within 30 days of purchase]

Name ..... Title .....

Company ..... Type of business .....

Address .....

City ..... Postal code .....

Country .....

Phone ..... Fax .....

E-mail .....

Easyrig serial No .....

Purchase location/company ..... Date .....

Please send to: Easyrig AB  
Anumark 231  
S-905 95 Umeå  
Sweden

or fax to: +46 90 77 60 01

**Thank you!**

*Easyrig* 3 **Gimbal-Rig**

